

*pneumatic gate  
for plastics*

# DOUBLE GROOVE

Miner's Double Groove pneumatic gate for plastics is simple to operate, clean and wash out, and provides a watertight seal when closed and locked. One of the most widely specified gates by plastic pellet shippers, the aluminum gate has a one-piece valve, and can be opened and closed with one hand. There are no additional lock latches or complex valve assemblies.



- ◀ Plastic pellets
- ◀ Dry resin

*Simple. Reliable. Proven.*



PERFECTING RAILCAR PERFORMANCE

# DOUBLE GROOVE

## PNEUMATIC GATE FOR PLASTICS

### Reliable Performance

Smooth surfaces, blended welds, no ledges or supports

Watertight construction

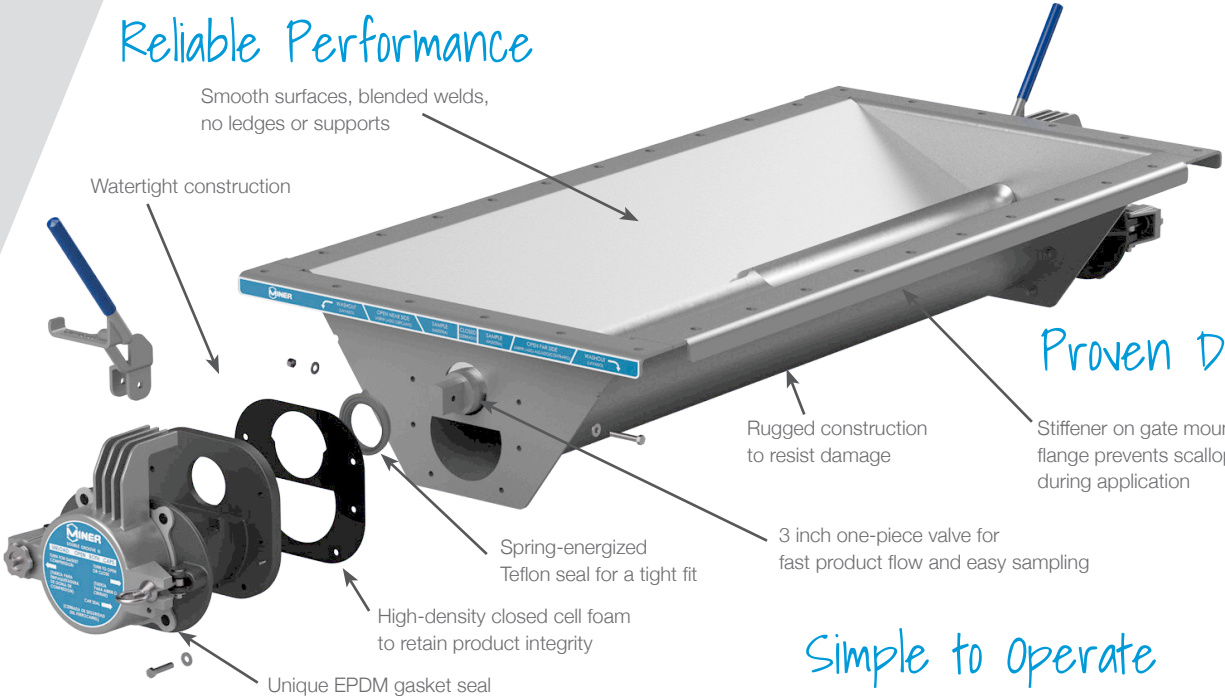

### Proven Design

Rugged construction to resist damage

Stiffener on gate mounting flange prevents scalloping during application

3 inch one-piece valve for fast product flow and easy sampling

Spring-energized Teflon seal for a tight fit

High-density closed cell foam to retain product integrity

Unique EPDM gasket seal

### Simple to Operate

Single handle eliminates confusion. Easily move positions from closed to sample, unload or cleanout.

### Easy to Maintain

Easier to wash out, with no worries about obstructions

Lowest number of commonly replaced parts

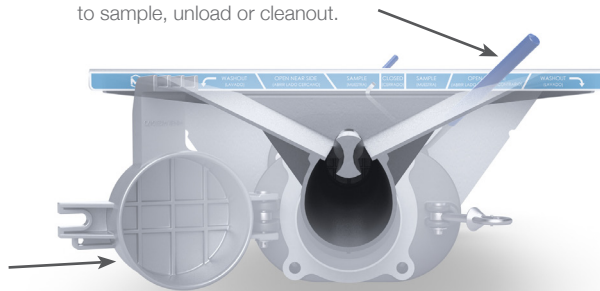

MKE10480-1

MKE10483-1

MKE10637-1

MKE10647-1

MKE10675-1

MKE10658-1

Bolt on working points	31.50" x 67.13"	29.81" x 75.81"	28.31" x 74.31"	31.50" x 67.13"	31.50" x 67.13"	30.38" x 66.00"
Overall gate height	13.31"	13.78"	13.78"	11.50"	11.50"	13.31"
Number of bolt holes	32	38	38	32	32	32
Weight	180 lbs	192 lbs	192 lbs	179 lbs	173 lbs	180 lbs
Typical service	Plastic Pellet / Powder Resins	Plastic Pellet / Powder Resins	Plastic Pellet / Powder Resins	Plastic Pellet / Powder Resins	Plastic Pellet / Powder Resins	Plastic Pellet / Powder Resins