

TecnPak® LT CCSB

TCC-III / TCC-IV

Miner long travel constant contact side bearings provide superior truck hunting, safer curve negotiation, maximum car body roll control and a longer railcar lifecycle.

- ◀ Maximum Energy Absorption
- ◀ Reduce Truck and Wheel Wear
- ◀ Maximize Side Bearing Life

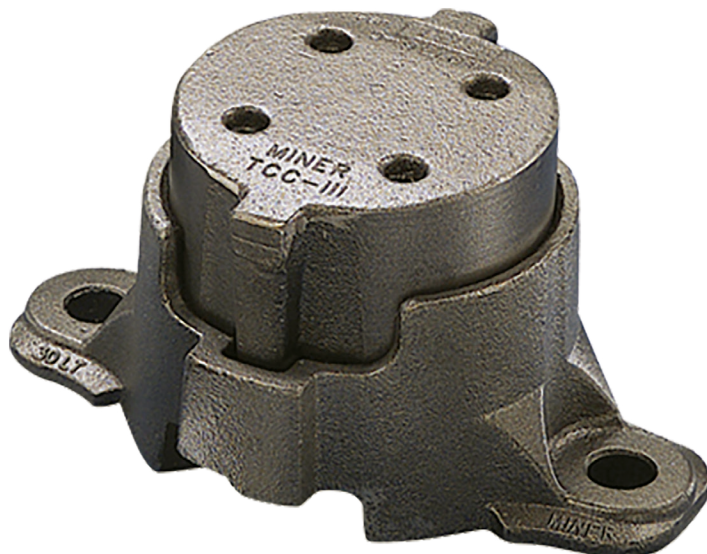

Protection. Reliability. Innovation.





PERFECTING RAILCAR PERFORMANCE

TCC-III / TCC-IV

TECSPA® LONG TRAVEL CONSTANT CONTACT SIDE BEARINGS

Selection Guide

	 80 LT (body weight > 37,647 lbs.)	 60 LT (body weight > 28,235 lbs.)	 45 LT (body weight > 21,176 lbs.)
COVERED HOPPER			
Steel Grain Car	TCC-III or IV		
Aluminum Grain Car		TCC-III or IV	
All other		TCC-III or IV	
OPEN TOP HOPPER			
Steel Coal Car	TCC-III or IV		
Aluminum Coal Car		TCC-III or IV	TCC-III or IV
All other		TCC-III or IV	
GONDOLA/COIL			
Steel Coal Car	TCC-III or IV		
Aluminum Coal Car			TCC-III or IV
All other		TCC-III or IV	
BOX			
All	TCC-III or IV		
TANK			
All		TCC-III or IV	
NON-INTERMODAL FLAT			
Bulkhead Flat Car	TCC-III or IV		
Autorack Car	TCC-III or IV		
Centerbeam Car		TCC-III or IV	
General Purpose 89' Flat		TCC-III or IV	
Heavy Duty Flat Car	(need more information for specific model)		
INTERMODAL			
Stand Alone Well		TCC-III or IV	
Drawbar Connected Well		TCC-III or IV	
Articulated Well	TCC-IV (need more information for specific model)		
Articulated Spine	TCC-IV (need more information for specific model)		

Note:

- Body weight equates to the light weight minus truck weight.
- Chart assumes set-up height is 5-1/16".
- Chart assumes standalone car with 2 trucks.
- For lightweight cars (body weight between 14,118 lbs. and 21,176 lbs.) Miner recommends the use of a 30 LT constant contact side bearing