

TecnPak® LT
LP CCSB retrofit kit

TCC-45 LTLP-C

Easy to install and maintain,
Miner TCC-45 LTLP-C
long travel constant contact
side bearings are designed
for a 2^{5/8}" low-profile application.



- ◀ Superior Truck Hunting Control
- ◀ Improved Curving Performance
- ◀ Maximum Car Body Control
- ◀ Delivers Greater Car Body Protection

Protection. Reliability. Innovation.



PERFECTING RAILCAR PERFORMANCE

TCC-45 LTLP-C

TECSPAK® LONG TRAVEL, LOW-PROFILE CONSTANT CONTACT SIDE BEARING RETROFIT KIT

The LTLP-C showcases a simple 3-piece design including top cap, pad, and housing. This makes this side bearing easy to install and maintain. The pad of the LTLP-C is Miner's exclusive TecsPak® pad, which is proven to provide a greater level of hunting control to the car body even under the most demanding conditions.

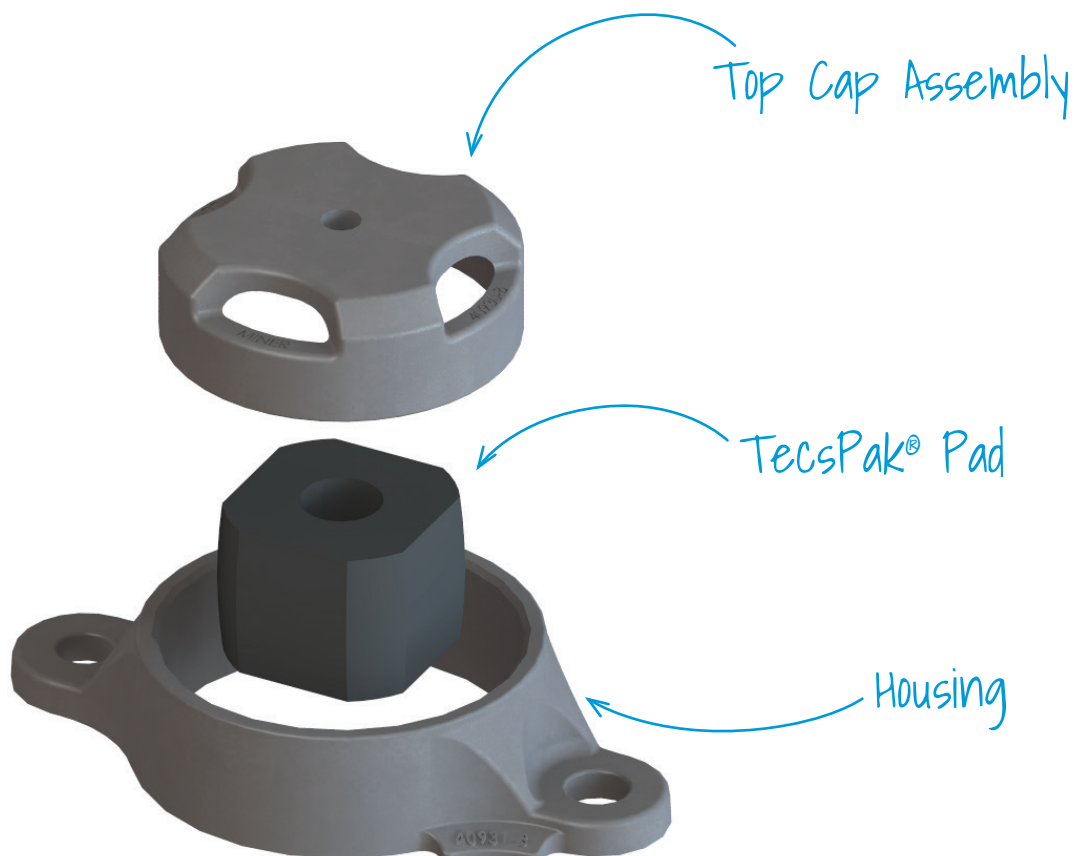

The TCC-45 LTLP-C is designed to operate at an installed height of 2-5/8" and provide 4,500 lbs. of preload and 5/8" of travel. It can also take the place of a friction block style bolster pocket when the 8.5-inch bolt pattern is available.