



©Miner Enterprises 2019



Universal Repair Flange

Installation Instruction

Revision A

3/8/2021

1. Cut running board to desired length.

Note: the repair flange is made of 12 Ga material and as such will add ≈ 0.1 " to the length of the board.

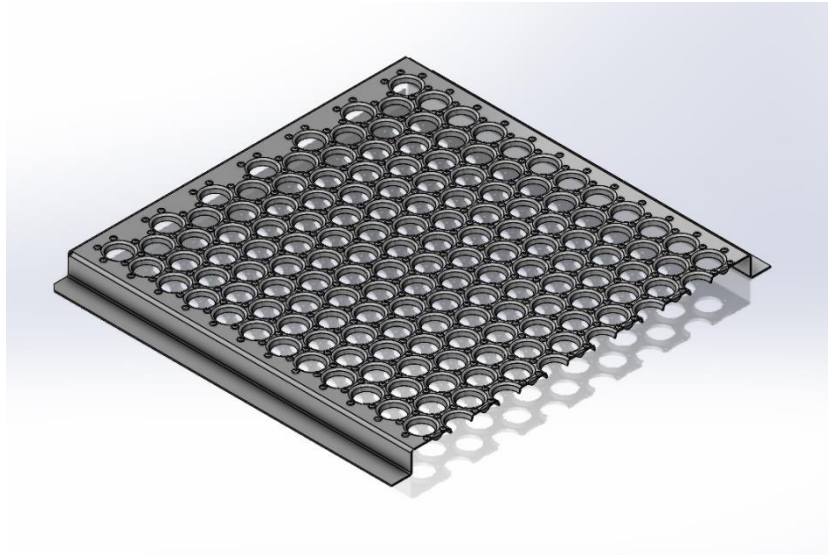

2. Slide the 400-0002 repair flange into the board.

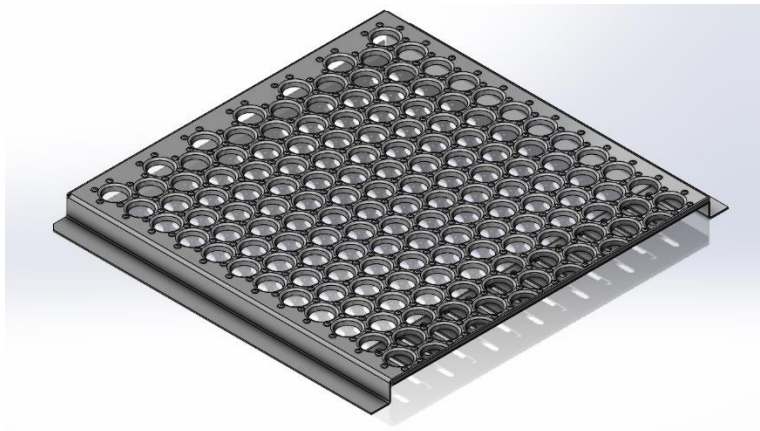
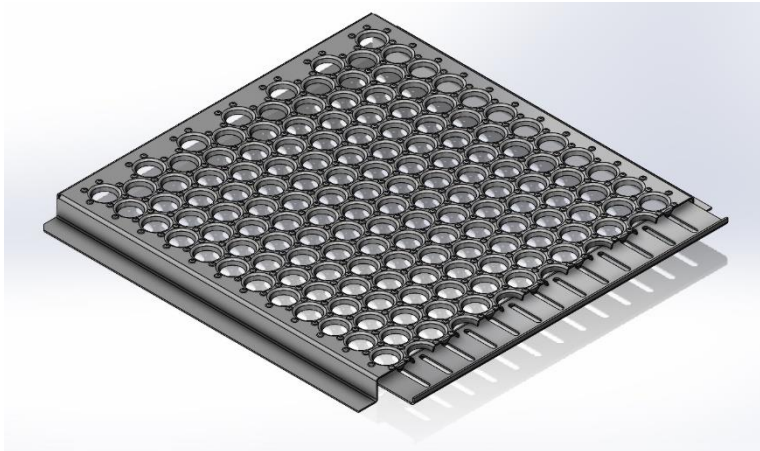

3. Apply the flange hardware through the first row of uncut holes.

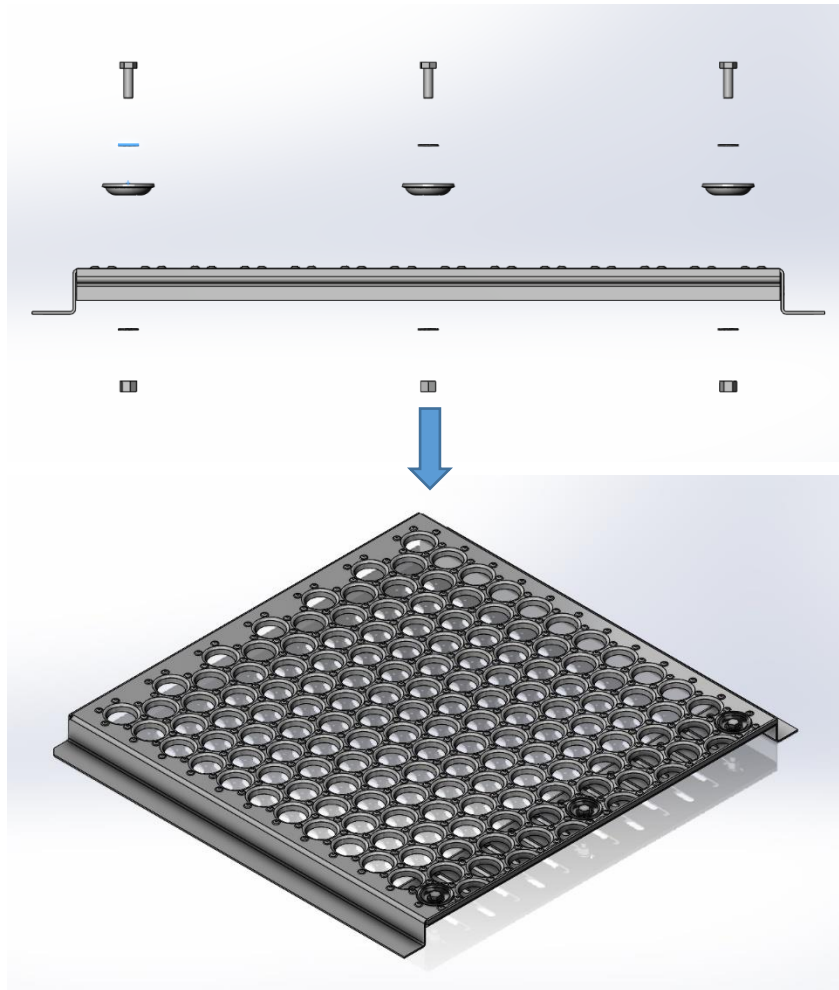

Recommended Hardware:

- 3X Grade 5 5/16-18 x1" Hex Bolt
Miner Part #: P30000290
- 6X 5/16 SAE washer
Miner Part #: P30000293
- 3X Cup Washer
Miner Part#: 405-0008
(for hole down Style)

Or

Miner Part#: 38S00055
(for hole up Style)
- 3X 5/16-18 Lock nut
Miner Part #: P30000277

Bolts should be tightened to 10-Ft-lbs

4. Drill mounting holes at desired location.

